

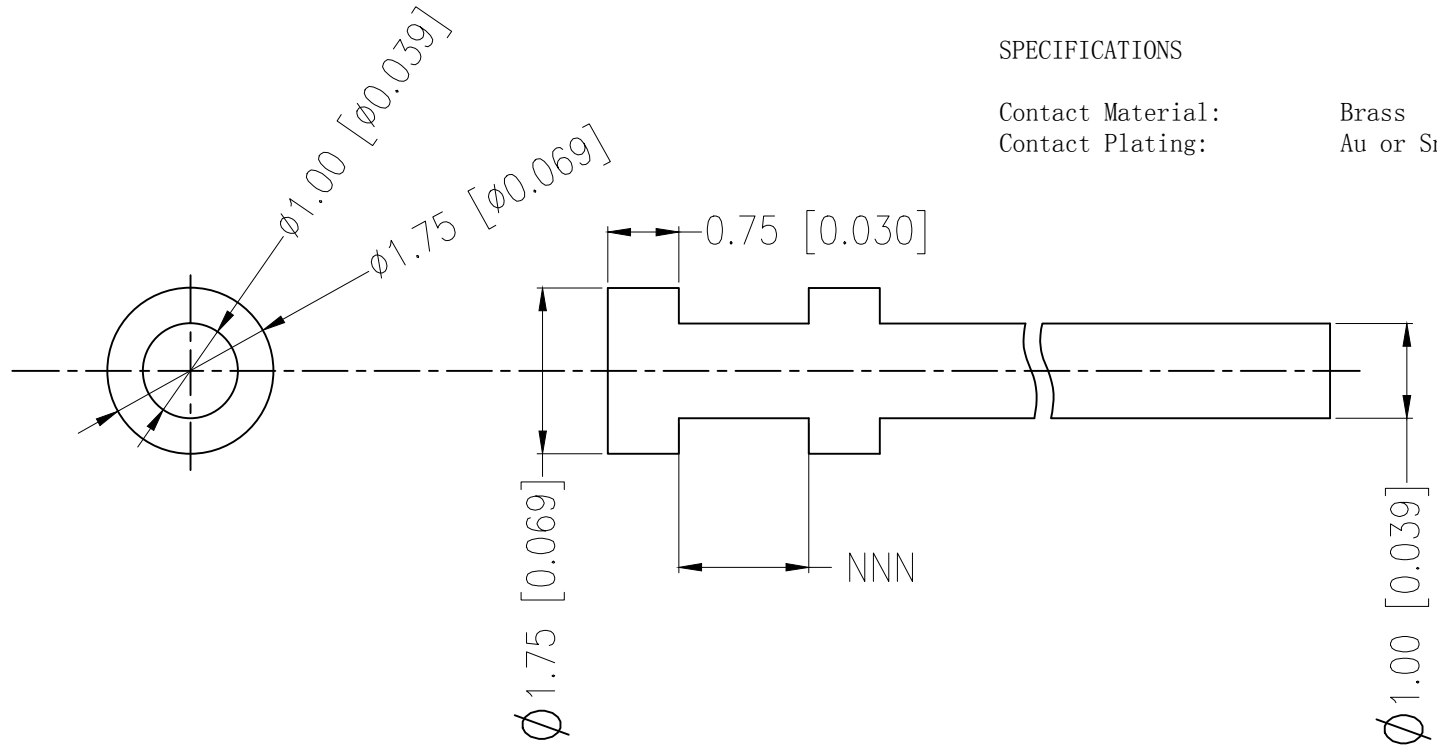

SPECIFICATIONS

Contact Material: Brass
 Contact Plating: Au or Sn over Ni



Any size and shape can be customized.
 Contact sales team for more information.

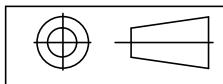

PRODUCT NAME	DIM	TOL	DWG NO.	DRAW	Wu	PART NO	CUST
1.0mm Terminal Pin	X.X	±0.4	P.W	CHECK	Tomy	UNIT	MM[INCH]
	X.XX	±0.25	MATER	BRASS	APPR	Allan	DATE
	ANGLE	±3°	REV.	A0			XXXX.XX.XX
						东莞市同盈电子有限公司 DONGGUAN WIN-WIN ELECTRONIC Co., Ltd.	