

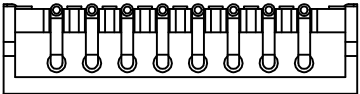

SPECIFICATION
 Current Rating:1.0Amp
 Voltage Rating:50V AC/DC
 Contact Resistance:20mΩ Max
 Withstand Voltage:500V AV/DC
 Insulation Resistance:500MΩ Min
 Operation Temperature:-25°C to +85°C

Contact Material: Brass
 Contact Plating:Au or Sn over Ni
 Insulator Material:PA6T+30%GF UL94V-0

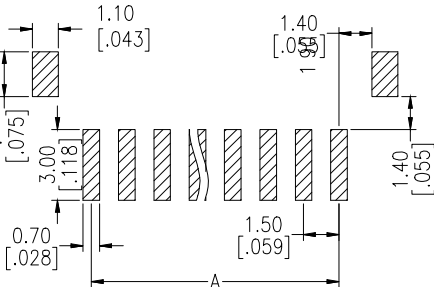
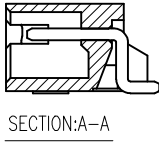
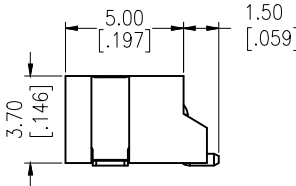
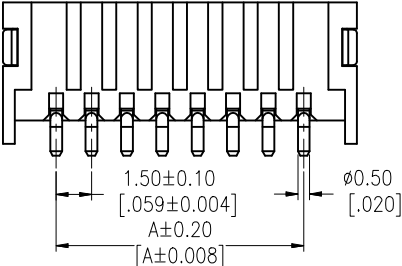
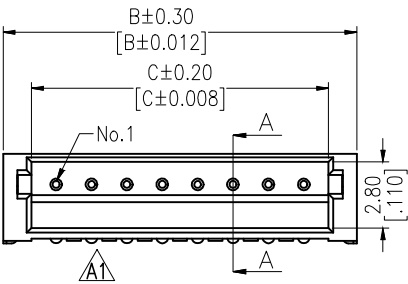

Circuit	Dimension		
	A	B	C
2	1.50	6.00	3.6
3	3.00	7.50	5.10
4	4.50	9.00	6.60
5	6.00	10.50	8.10
6	7.50	12.00	9.60
7	9.00	13.50	11.10
8	10.50	15.00	12.60
9	12.00	16.50	14.10
10	13.50	18.00	15.60
11	15.00	19.50	17.10
12	16.50	21.00	18.60
13	18.00	22.50	20.10
14	19.50	24.00	21.60
15	21.00	25.50	23.10
16	22.50	27.00	24.60
17	24.00	28.50	25.10
18	25.50	30.00	26.60
19	27.00	31.50	28.10
20	28.50	33.00	29.60

Recommended P.C.B Layout
 (PCB BOARD TOLERANCE±0.05)

Any size and shape can be customized.
 Contact sales team for more information.

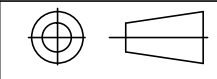

PRODUCT NAME	DIM	TOL	DWG NO.	DRAW	Wu	PART NO	CUST
1.5MM Wafer 90° SMT Series	X. X	±0.4	P. W	CHECK	Tomy	UNIT	DATE
	X. XX	±0.25	MATER	APPR	Allan	MM[INCH]	XXXX. XX. XX
	ANGLE	±3°	REV.			东莞市同盈电子有限公司 DONGGUAN WIN-WIN ELECTRONIC Co., Ltd.	