

SPECIFICATIONS

Current Rating: 3Amp
 Contact Resistance: 20mΩ Max
 Withstand Voltage: 1000V AC/DC
 Insulation Resistance: 1000MΩ Min
 Operation Temperature: -40°C~105°C
 Contact Material: Brass
 Contact Plating: Au or Sn over Ni
 Insulation Material: PA9T+30GF (UL94V-0)

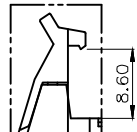
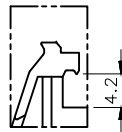
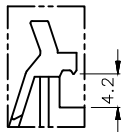
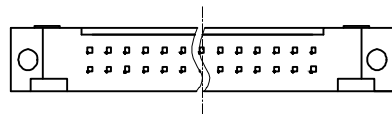

SPECIL LATCH

SHORT LATCH

STANDARD LATCH

AVAILABLE DIMENSION TABLE

No. of Contacts	10	14	16	20	26	30	34	40	50	60	64
A	31.92	37.00	39.54	44.62	52.24	57.32	62.40	70.02	82.72	95.42	100.50
B	21.72	26.80	29.34	34.42	42.04	47.12	52.20	59.82	72.52	85.22	90.30
C	10.16	15.24	17.78	22.86	30.48	35.56	40.64	48.26	60.96	73.66	78.74
D	18.22	23.30	25.84	30.92	38.54	43.62	48.70	56.32	69.02	81.72	86.80

Any size and shape can be customized.
 Contact sales team for more information.

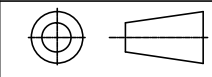

PRODUCT NAME	DIM	TOL	DWG NO.	DRAW	Wu	PART NO	CUST
	X.X	±0.4	P.W	CHECK	Tomy	UNIT	DATE
	X.XX	±0.25	MATER	APPR	Allan	MM[INCH]	XXXX.XX.XX
2.54MM EJECTOR HEADER SERIES	ANGLE	±3°	REV.				
						东莞市同盈电子有限公司 DONGGUAN WIN-WIN ELECTRONIC Co., Ltd.	