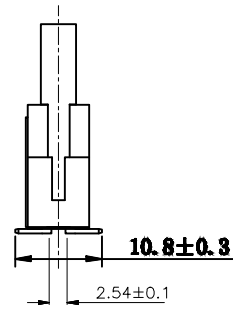

FIGURE A



V/T TYPE

SPECIFICATIONS

- Current Rating: 3Amp
- Contact Resistance: 20mΩ Max
- Withstand Voltage: 1000V AC/DC
- Insulation Resistance: 1000MΩ Min
- Operation Temperature: -40°C~105°C
- Contact Material: Brass
- Contact Plating: Au or Sn over Ni
- Insulation Material: PA9T+30GF(UL94V-0)

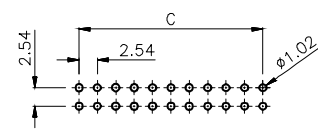
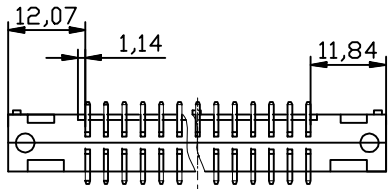

V/T TYPE

Latch Type	DIM.	
		F
Standard Latch		3.10
Standard Latch		8.10

Any size and shape can be customized.  
Contact sales team for more information.

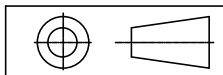

PRODUCT NAME	DIM	TOL	DWG NO.	DRAW	Wu	PART NO	CUST
2.54MM EJECTOR HEADER SERIES	X.X	±0.4	P.W	CHECK	Tomy	UNIT	DATE
	X.XX	±0.25	MATER	PA9T、BRASS		MM[INCH]	XXXX.XX.XX
	ANGLE	±3°	REV.	A0	APPR	Allan	
						东莞市同盈电子有限公司 DONGGUAN WIN-WIN ELECTRONIC Co., Ltd.	