

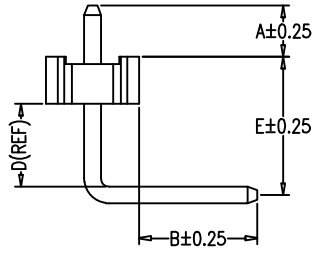

**SPECIFICATIONS**

Current Rating: 7.0 AMP  
 Contact Resistance: 20mΩ Max.  
 Withstand Voltage: AC/DC 1000V  
 Insulator Resistance: 1000 MΩ Min  
 Operating Temp.: -40°C ~ +105°C  
 Contact Material: Brass  
 Contact Plating: Au or Sn over Ni  
 Insulator Material: PA6T Black+30%GF UL94V-0 BK

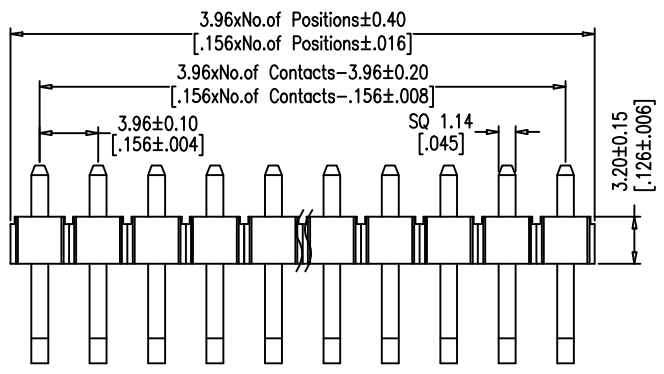
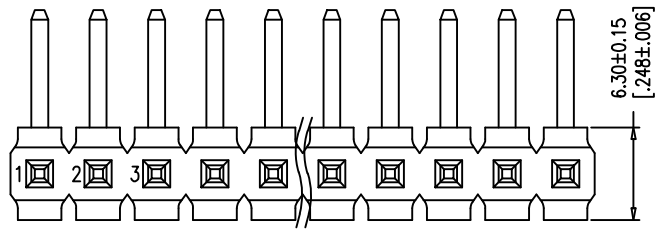

PIN Number	Dimension (mm)	
	A	B
1*1P	.....	3.96
1*2P	3.96	7.92
1*3P	7.92	11.88
1*4P	11.88	15.84
1*5P	15.84	19.80
1*6P	19.80	23.76
1*7P	23.76	27.72
1*8P	27.72	31.68
1*9P	31.68	35.64
1*10P	35.64	39.60
1*11P	39.60	43.56
1*12P	43.56	47.52
1*13P	47.52	51.48
1*14P	51.48	55.44
1*15P	55.44	59.40
1*16P	59.40	63.36
1*17P	63.36	67.32
1*18P	67.32	71.28
1*19P	71.28	75.24
1*20P	75.24	79.20



Recommended P.C.B Layout (Top Side)  
 (PCB BOARD TOLERANCE±0.05)

Any size and shape can be customized.  
 Contact sales team for more information.

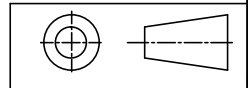

PRODUCT NAME	DIM	TOL	DWG NO.	DRAW	Wu	PART NO	CUST
3.96 MM SINGLE ROW PIN HEADER RIGHT-ANGLE	X. X	±0.4	P. W	CHECK	Tomy	UNIT	DATE
	X. XX	±0.25	MATER PA6T、BRASS	APPR	Allan	MM[INCH]	XXXX. XX. XX
	ANGLE	±3°	REV. A0	东莞市同盈电子有限公司 DONGGUAN WIN-WIN ELECTRONIC Co.,Ltd.			