

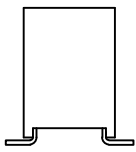

SPECIFICATIONS

Current Rating: 3.0 AMP
 Contact Resistance: 20mΩ Max.
 Withstand Voltage: AC/DC 500V
 Insulator Resistance: 1000 MΩ Min
 Operating Temp.: -40°C ~ +105°C
 Contact Material: Brass
 Contact Plating: Au or Sn over Ni
 Insulator Material: PA6T Black+30%GF UL94V-0 BK

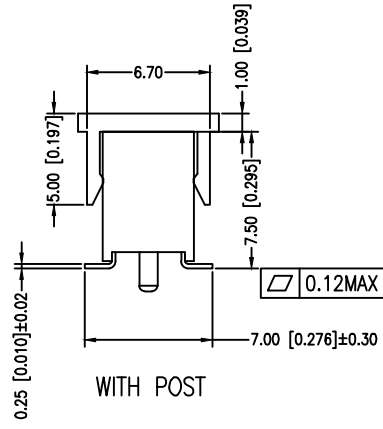
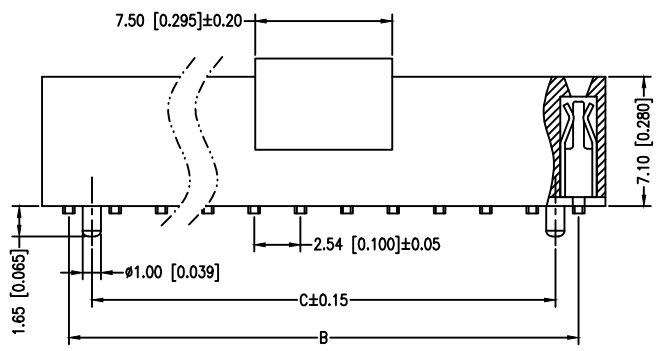
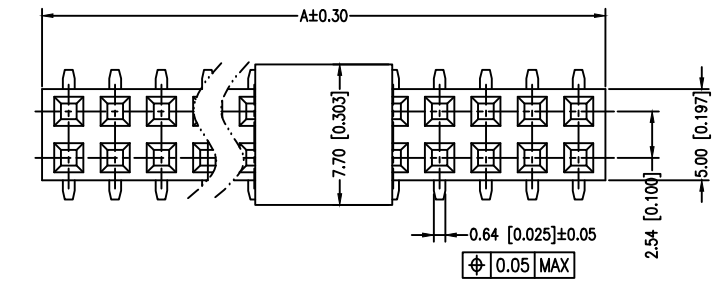

W/O POST

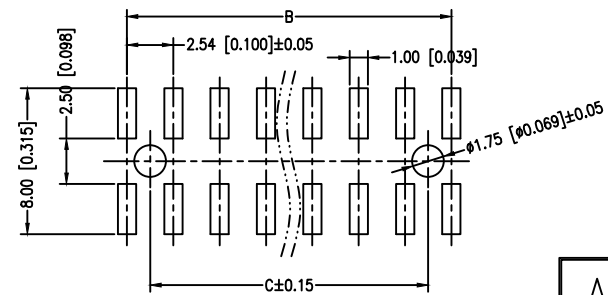

Recommended P.C.B Layout

PIN 数	DIM A	DIM B	DIM C	PIN 数	DIM A	DIM B	DIM C
2*2PIN	5.48	2.54		2*22PIN	56.28	53.34	50.80
2*3PIN	8.02	5.08	2.54	2*23PIN	58.82	55.88	53.34
2*4PIN	10.56	7.62	5.08	2*24PIN	61.36	58.42	55.88
2*5PIN	13.10	10.16	7.62	2*25PIN	63.90	60.96	58.42
2*6PIN	15.64	12.70	10.16	2*26PIN	66.44	63.50	60.96
2*7PIN	18.18	15.24	12.70	2*27PIN	68.98	66.04	63.50
2*8PIN	20.72	17.78	15.24	2*28PIN	71.52	68.58	66.04
2*9PIN	23.26	20.32	17.78	2*29PIN	74.06	71.12	68.58
2*10PIN	25.80	22.86	20.32	2*30PIN	76.60	73.66	71.12
2*11PIN	28.34	25.40	22.86	2*31PIN	79.14	76.20	73.66
2*12PIN	30.88	27.94	25.40	2*32PIN	81.68	78.74	76.20
2*13PIN	33.42	30.48	27.94	2*33PIN	84.22	81.28	78.74
2*14PIN	35.96	33.02	30.48	2*34PIN	86.76	83.82	81.28
2*15PIN	38.50	35.56	33.02	2*35PIN	89.30	86.36	83.82
2*16PIN	41.04	38.10	35.56	2*36PIN	91.84	88.90	86.36
2*17PIN	43.58	40.64	38.10	2*37PIN	94.38	91.44	88.90
2*18PIN	46.12	43.18	40.64	2*38PIN	96.92	93.98	91.44
2*19PIN	48.66	45.72	43.18	2*39PIN	99.46	96.52	93.98
2*20PIN	51.20	48.26	45.72	2*40PIN	102.0	99.06	96.52
2*21PIN	53.74	50.80	48.26				

Any size and shape can be customized.
 Contact sales team for more information.

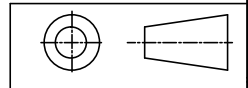

PRODUCT NAME	DIM	TOL	DWG NO.	DRAW	Wu	PART NO	CUST
2.54MM FEMALE HEADER SERIES	X. X	±0.4	P. W	CHECK	Tomy	UNIT	DATE
	X. XX	±0.25	MATER	PA6T、BRASS	Allan	MM[INCH]	XXXX. XX. XX
	ANGLE	±3°	REV.	A0		东莞市同盈电子有限公司 DONGGUAN WIN-WIN ELECTRONIC Co.,Ltd.	