

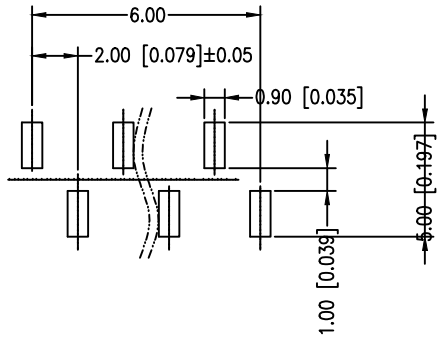

SPECIFICATIONS

Current Rating: 2.0 AMP
 Contact Resistance: 20mΩ Max.
 Withstand Voltage: AC/DC 500V
 Insulator Resistance: 1000 MΩ Min
 Operating Temp.: -40°C ~ +105°C
 Contact Material: Brass
 Contact Plating: Au or Sn over Ni
 Insulator Material: PA6T Black+30%GF UL94V-0 BK

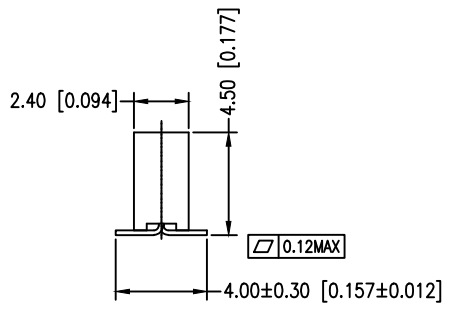
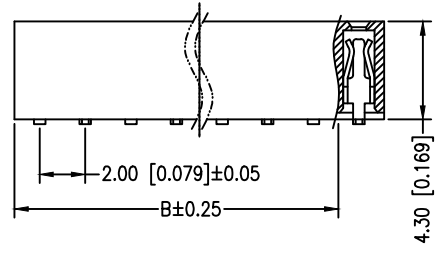
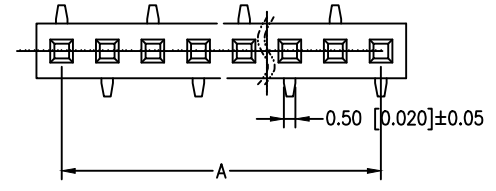

Recommended P.C.B Layout

Any size and shape can be customized.
 Contact sales team for more information.

| PIN Number | Dimension (mm) | | PIN Number | Dimension (mm) | |
|------------|----------------|-------|------------|----------------|-------|
| | A | B | | A | B |
| 1*2P | 2.00 | 4.60 | 1*21P | 40.00 | 42.60 |
| 1*3P | 4.00 | 6.60 | 1*22P | 42.00 | 44.60 |
| 1*4P | 6.00 | 8.60 | 1*23P | 44.00 | 46.60 |
| 1*5P | 8.00 | 10.60 | 1*24P | 46.00 | 48.60 |
| 1*6P | 10.00 | 12.60 | 1*25P | 48.00 | 50.60 |
| 1*7P | 12.00 | 14.60 | 1*26P | 50.00 | 52.60 |
| 1*8P | 14.00 | 16.60 | 1*27P | 52.00 | 54.60 |
| 1*9P | 16.00 | 18.60 | 1*28P | 54.00 | 56.60 |
| 1*10P | 18.00 | 20.60 | 1*29P | 56.00 | 58.60 |
| 1*11P | 20.00 | 22.60 | 1*30P | 58.00 | 60.60 |
| 1*12P | 22.00 | 24.60 | 1*31P | 60.00 | 62.60 |
| 1*13P | 24.00 | 26.60 | 1*32P | 62.00 | 64.60 |
| 1*14P | 26.00 | 28.60 | 1*33P | 64.00 | 66.60 |
| 1*15P | 28.00 | 30.60 | 1*34P | 66.00 | 68.60 |
| 1*16P | 30.00 | 32.60 | 1*35P | 68.00 | 70.60 |
| 1*17P | 32.00 | 34.60 | 1*36P | 70.00 | 72.60 |
| 1*18P | 34.00 | 36.60 | 1*37P | 72.00 | 74.60 |
| 1*19P | 36.00 | 38.60 | 1*38P | 74.00 | 76.60 |
| 1*20P | 38.00 | 40.60 | 1*39P | 76.00 | 78.60 |
| | | | 1*40P | 78.00 | 80.60 |

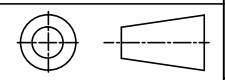

| PRODUCT NAME | DIM | TOL | DWG NO. | DRAW | Wu | PART NO | CUST |
|-----------------------------|-------|-------|------------------|-----------------------------------------------------|-------|----------|--------------|
| 2.0 MM FEMALE HEADER SERIES | X. X | ±0.4 | P. W | CHECK | Tomy | UNIT | DATE |
| | X. XX | ±0.25 | MATER PA6T、BRASS | APPR | Allan | MM[INCH] | XXXX. XX. XX |
| | ANGLE | ±3° | REV. AO | 东莞市同盈电子有限公司 DONGGUAN WIN-WIN ELECTRONIC Co.,Ltd. | | | |